

Varsity Floor Case Collection (694 & 691)

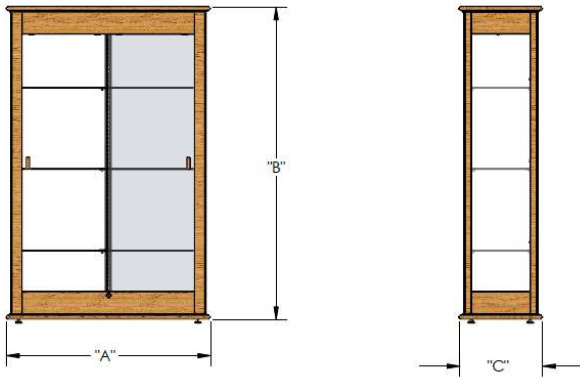

	"A"	"B"	"C"
691K-XX-XX	50-1/4"	76-3/4"	20-3/8"
694K-XX-XX	38-1/4"	76-3/4"	20-3/8"

Shelving:

- 3 Full Size Shelves
 - 694 Shelf Dimensions: 35" x 14 1/4" x 1/4"
 - 691 Shelf Dimensions: 45" x 14 1/4" x 1/4"
- The case utilizes a standard for shelf adjustments in 1" increments.
- Each shelf has a capacity of 25 lbs.

Doors:

- Sliding doors that open from both sides for easy access. Door handles are stained to match the case.
- Lock mechanism is the Selby-033 cam lock that comes with 2 keys.

Lighting:

- Lighted units come with LED strip lights with a 10' cord and case-mounted on/off switch.

Materials:

- Case frame is made of oak wood.
- Cases are available in a variety of wood stain finishes. Color matching is available.
- Cases are available with a variety of back options.

Assembly/Weight/Shipping:

- Cases arrive semi-assembled. Installers will need to unpack/untape the unit, install the shelves, install the door handles, and level the case. Tip protection is also provided and must be installed to meet furniture tip over requirements.
- Cases vary from 230 to 300 lbs.
- Cases will arrive on a pallet shrink-wrapped and packaged for safe arrival.

