

## Heritage Floor Case Collection (891, 893)

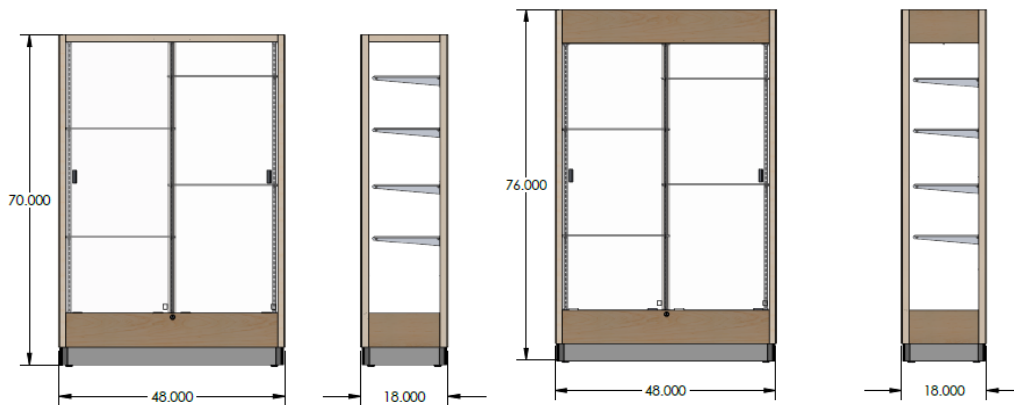

### Shelving:

- 4 Half-Size Shelves
  - Shelf Dimensions: 23 7/16" x 13 27/32" x 1/4"
- The case utilizes a standard for shelf adjustments in 1" increments.
- Each shelf has a capacity of 25 lbs.

### Doors:

- Sliding doors that open from both sides for easy access. Door handles are satin aluminum.
- Lock mechanism is the Selby-033 cam lock that comes with 2 keys.

### Lighting:

- Lighting is not available on the 891 unit. LED lighting is standard in the 893 unit.

### Materials:

- Case frame is made of poplar wood.
- Cases are available in a variety of wood stain finishes. Color matching is available.
- Cases are available with a variety of back options.

### Assembly/Weight/Shipping:

- Cases arrive semi-assembled. Installers will need to unpack/untape the unit, install the shelves, install the door handles, and level the case. Tip protection is also provided and must be installed to meet furniture tip over requirements.
- Cases vary from 220 to 300 lbs.
- Cases will arrive on a pallet shrink-wrapped and packaged for safe arrival.

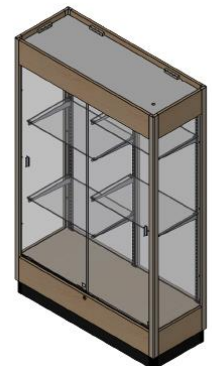

## Heritage Floor Case Collection (8949)

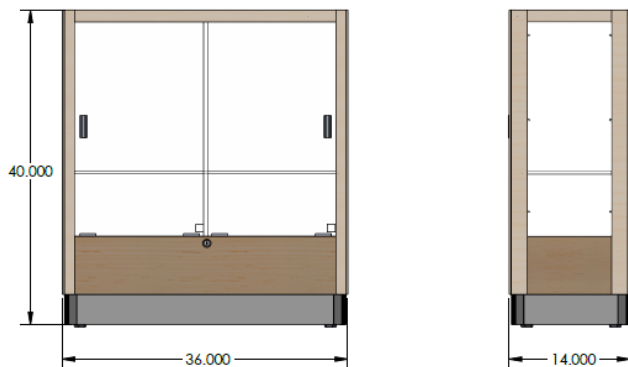

### Shelving:

- 1 Full-Size Shelves
  - Shelf Dimensions: 12"x34"x1/4"
- Support wires allow for some adjustability in the shelf.
- The shelf has a capacity of 25 lbs.

### Doors:

- Sliding doors that open from both sides for easy access. Door handles are satin aluminum.
- Lock mechanism is the Selby-033 cam lock that comes with 2 keys.

### Lighting:

- Lighting is not available on the 8949 unit.

### Materials:

- Case frame is made of poplar wood.
- Cases are available in a variety of wood stain finishes. Color matching is available.
- Cases are available with a variety of back options.

### Assembly/Weight/Shipping:

- Cases arrive semi-assembled. Installers will need to unpack/untape the unit, install the shelves, install the door handles, and level the case. Tip protection is also provided and must be installed to meet furniture tip over requirements.
- Cases are approximately 115 lbs.
- Cases will arrive on a pallet shrink-wrapped and packaged for safe arrival.

