

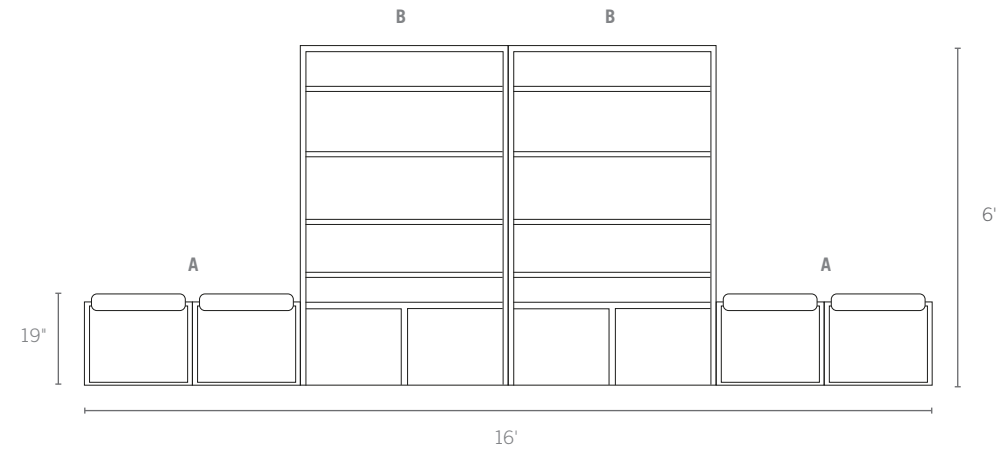

# TYPICAL CONFIGURATIONS

Lobbies and Reception Areas



Label	ID	Description	Quantity	List Price
A	DEF4B_	19"H x 48"W Define Bench Unit with Fabric Seating	2	\$11,026
B	DEF4S_	6'H x 4'W Define Shelf Display Unit	2	\$13,780

**Total: \$24,806**

Lobbies and Reception Areas

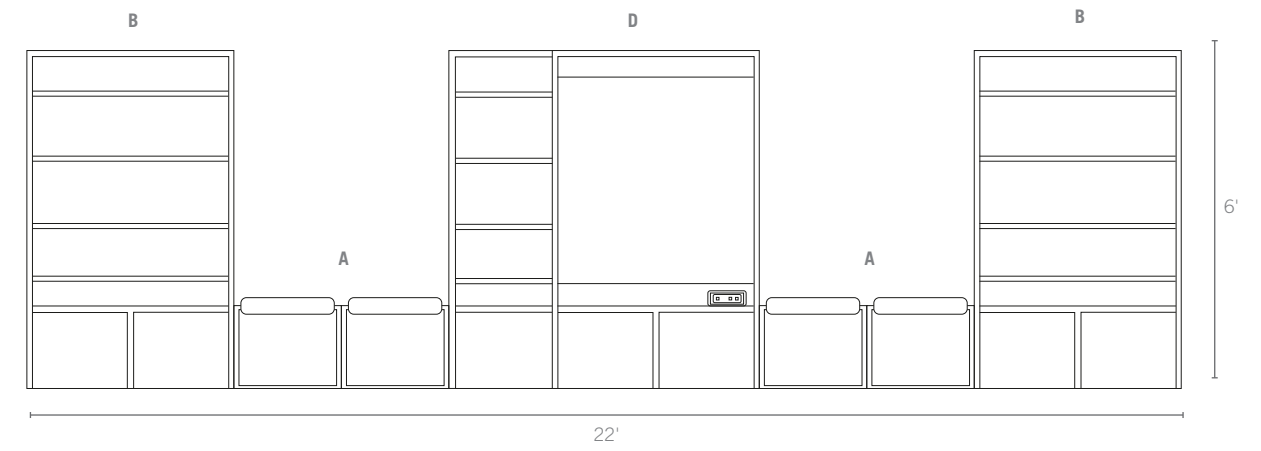

Label	ID	Description	Quantity	List Price
B	DEF4S_	6'H x 4'W Define Shelf Display Unit	2	\$13,780
A	DEF4B_	19"H x 48"W Define Bench Unit with Fabric Seating	2	\$11,026
D	DEF6C_E	6' Define Collaboration Unit with Electric	1	\$10,473
	DEFA4845_	Side 1: 48"H x 45"W Acoustic Panel	1	\$1,378
	DEF6SM4845_	Side 2: 48"H x 45"W Magnetic Glassboard	1	\$2,894

**Total: \$39,551**

Open Work Areas

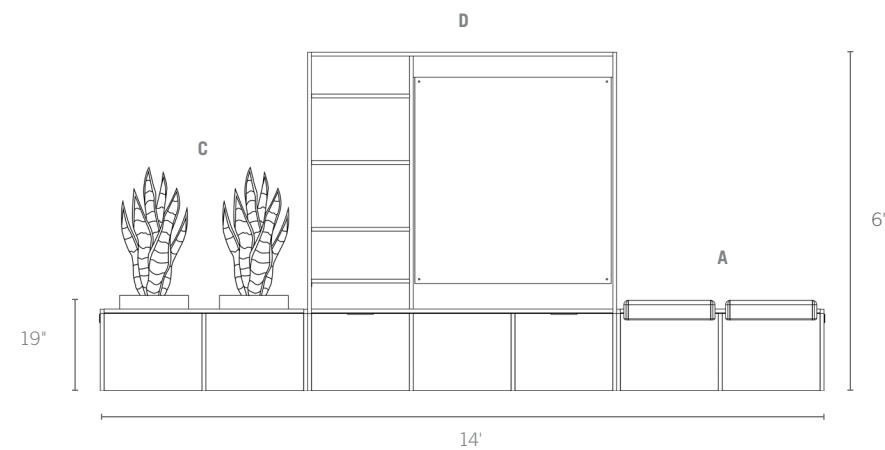

Label	ID	Description	Quantity	List Price
C	DEF4P_	19"H x 48"W Define Planter Unit (Plants not included)	1	\$3,859
D	DEF6C_	6'H x 6'W Define Collaboration Unit	1	\$7,993
	DEF6SN4845_	Side 1: 48"H x 45"W Non-Magnetic Glassboard	1	\$2,205
	DEFM4845_	Side 2: 48"H x 45"W Acoustic Panel with Monitor Mount	1	\$1,654
A	DEF4B_	19"H x 48"W Define Bench Unit	1	\$5,513

**Total: \$21,224**

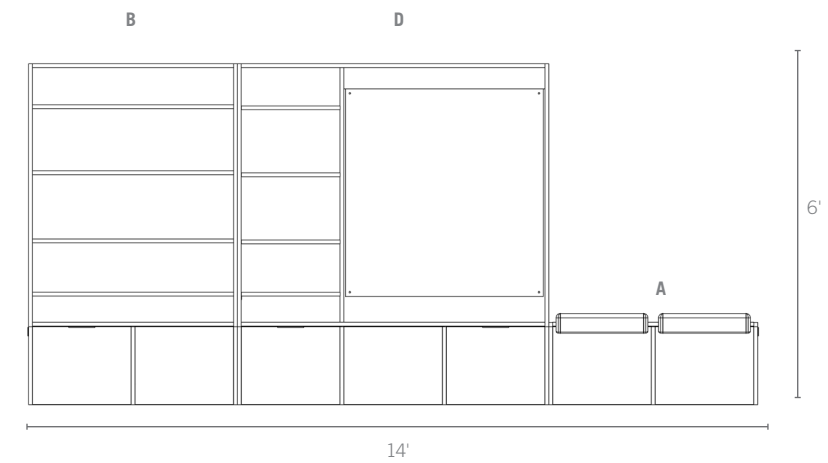

Label	ID	Description	Quantity	List Price
B	DEF4S_	6'H x 4'W Define Shelf Display Unit	1	\$6,890
D	DEF6C_	6'H x 6'W Define Collaboration Unit	1	\$7,993
	DEF6SM4845_	Side 1: 48"H x 45"W Magnetic Glassboard	1	\$2,894
	DEFA4845_	Side 2: 48"H x 45"W Acoustic Panel	1	\$1,378
A	DEF4B_	19"H x 48"W Define Bench Unit	1	\$5,513

**Total: \$24,668**

## Open Work Areas

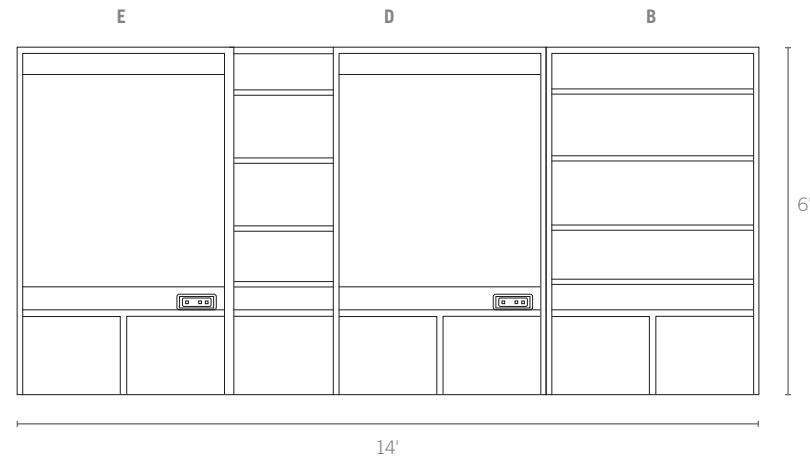

Label	ID	Description	Quantity	List Price
E	DEF4C_E	6'H x 4'W Define Collaboration Unit with Electric	1	\$8,874
	DEFT4845_	Side 1: 48"H x 45"W Fabric Tackboard	1	\$1,034
	DEFGSM4845_	Side 2: 48"H x 45"W Magnetic Glassboard	1	\$2,894
D	DEF6C_E	6'H x 6'W Define Collaboration Unit with Electric	1	\$10,473
	DEFA4845_	Side 1: 48"H x 45"W Acoustic Panel	1	\$1,378
	DEFGSM4845_	Side 2: 48"H x 45"W Magnetic Glassboard	1	\$2,894
B	DEF4S_	6'H x 4'W Define Shelf Display Unit	1	\$6,890
<b>Total: \$34,437</b>				

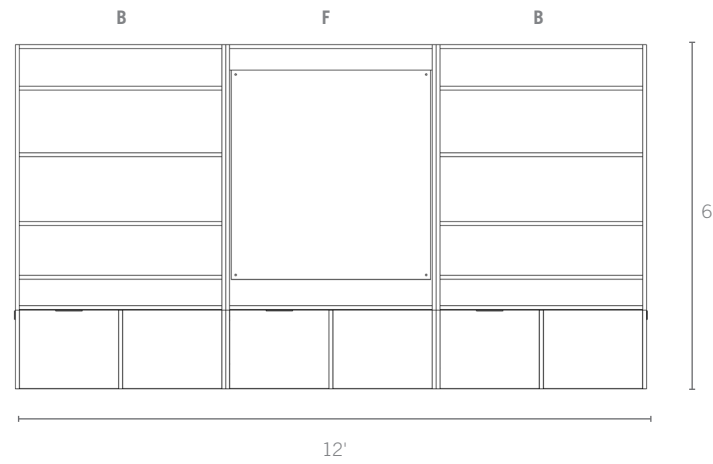

Label	ID	Description	Quantity	List Price
B	DEF4S_	6'H x 4'W Define Shelf Display Unit	2	\$13,780
F	DEF4C_	4'H x 4'W Define Collaboration Unit	1	\$6,394
	DEFGSM4845_	Side 1: 48"H x 45"W Magnetic Glassboard	1	\$2,894
	DEFT4845_	Side 2: 48"H x 45"W Fabric Tackboard	1	\$1,034
<b>Total: \$24,102</b>				

Please see our Define Price Guide to choose laminate and panel color options and item numbers.

## Corporate Lounges

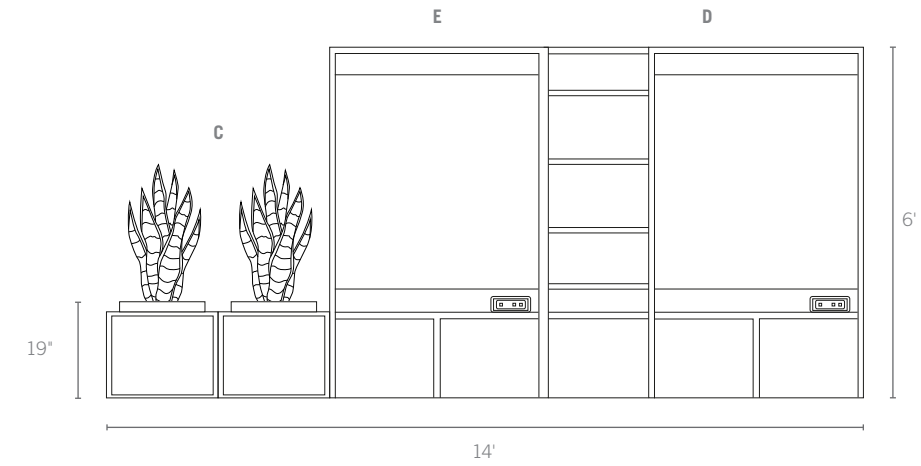

Label	ID	Description	Quantity	List Price
C	DEF4P_	19"H x 48"W Define Planter Unit (Plants not included)	1	\$3,859
E	DEF4C_E	6'H x 4'W Define Collaboration Unit with Electric	1	\$8,874
	DEFW4845_	Side 1: 48"H x 45"W Laminate Whiteboard	1	\$1,034
	DEFGSM4845_	Side 2: 48"H x 45"W Magnetic Glassboard	1	\$2,894
D	DEF6C_E	6'H x 6'W Define Collaboration Unit with Electric	1	\$10,473
	DEFT4845_	Side 1: 48"H x 45"W Fabric Tackboard	1	\$1,034
	DEFW4845_	Side 2: 48"H x 45"W Laminate Whiteboard	1	\$1,034
<b>Total: \$29,202</b>				

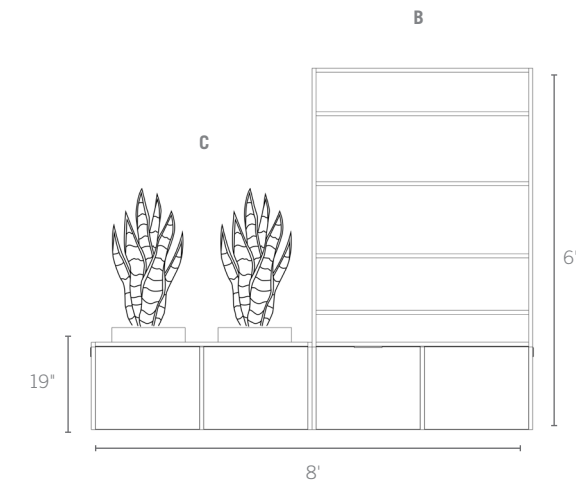

Label	ID	Description	Quantity	List Price
C	DEF4P_	19"H x 48"W Define Planter Unit (Plants not included)	1	\$3,859
B	DEF4S_	6'H x 4'W Define Shelf Display Unit	1	\$6,890
<b>Total: \$10,749</b>				

Please see our Define Price Guide to choose laminate and panel color options and item numbers.