

Colossus Floor Case Collection (2605, 2606)

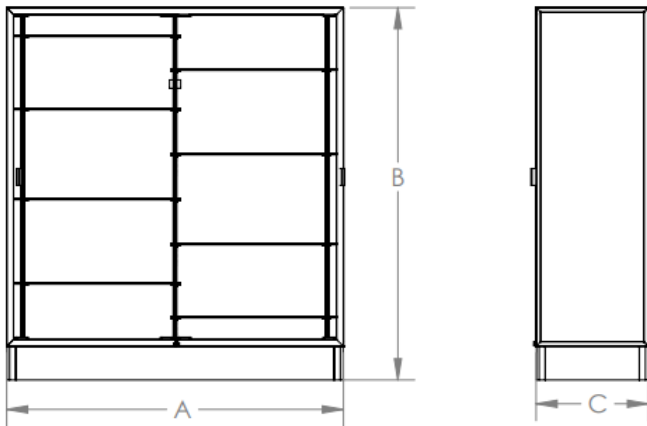

	A	B	C
2605-XX-XX	60"	66"	20"
2606-XX-XX	72"	66"	20"

Shelving:

- 8 Half-Size Shelves
 - 5' Shelf Dimensions: 29 ½" x 14" x ¼"
 - 6' Shelf Dimensions: 35 ½" x 14" x ¼"
- The case utilizes a standard for shelf adjustments in 1" increments.
- Each shelf has a capacity of 25 lbs.

Doors:

- Sliding doors that open from both sides for easy access. Door handles come in bronze or satin to match the case.
- Lock mechanism is the Selby-033 cam lock that comes with 2 keys.

Lighting:

- Not available on the standard unit.

Materials:

- Case frame is made of anodized aluminum in a variety of colors.
- Cases are available with a variety of back options including custom printed options.

Assembly/Weight/Shipping:

- Cases arrive semi-assembled. Installers will need to unpack/untape the unit, install the shelves, install the door handles, and level the case. Tip protection is also provided and must be installed to meet furniture tip over requirements.
- Cases vary from 375 to 475 lbs.
- Cases will arrive on a pallet shrink-wrapped and packaged for safe arrival.

